

## Art Institute of Chicago - Modern Wing

Chicago, Illinois

*clever. creative. comfort.*

Client - Art Institute of Chicago  
 Representative Office - Air Products Equipment  
 Architect - Renzo Piano  
 LEED Certification - none



### ABOUT THE PROJECT

The latest addition to the Art Institute of Chicago is the Modern Wing. It houses an immense collection of 20th and 21st-century art. Designed by the renowned Pritzker Prize-winning architect Renzo Piano, the Modern Wing contains modern European paintings and sculptures, contemporary art, architecture and design, and photography.

The Modern Wing is a 264,000 square-foot building that utilizes many sustainable features throughout. The focus of the architect was to create an impressive space that maximized the use of natural resources while minimizing the impact on the environment. On the exterior, a sunshade system is featured. This unique system filters sunlight into the building, thus saving on electricity. The interior lighting system compensates and adjusts the lights to maximize the usage of interior lights. The Modern Wing also uses a state-of-the-art HVAC system as well.

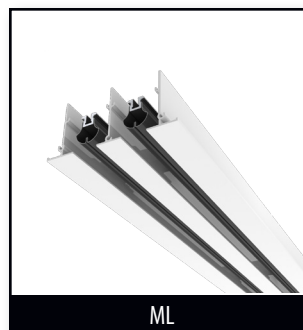

ML



TMRA-AA



300/350R



MP



# Art Institute of Chicago - Modern Wing

Chicago, Illinois



## THE TITUS SOLUTION

For high profile projects, Titus has a myriad of products available that not only blend well into any ceiling application, but provide superior performance. We provided several grilles and diffusers for this project, but the primary source of air distribution utilized is the ML.

The Titus ML is a modular high performance, high quality linear slot ceiling diffuser. It is designed for variable air volume systems and projects a uniform blanket of air that adheres to the ceiling even at low flow rates. The unique "ice tong" deflector blades allows for changes in air volume and direction from the face of the diffuser by gradually moving the pattern controllers.

Among the many other products that can be seen throughout the new wing are the TMRA-AA, 300/350R grilles and the MP. The TMRA-AA is an adjustable round ceiling diffuser designed for both heating and cooling applications. All sizes have four cones, giving uniformity of appearance where different sizes are used in the same area. It delivers a uniform 360° air discharge pattern and exhibits excellent performance in variable air volume systems. Titus' 300/350 series grilles define the standard for the industry. These grilles form the back bone of a standard offering that will

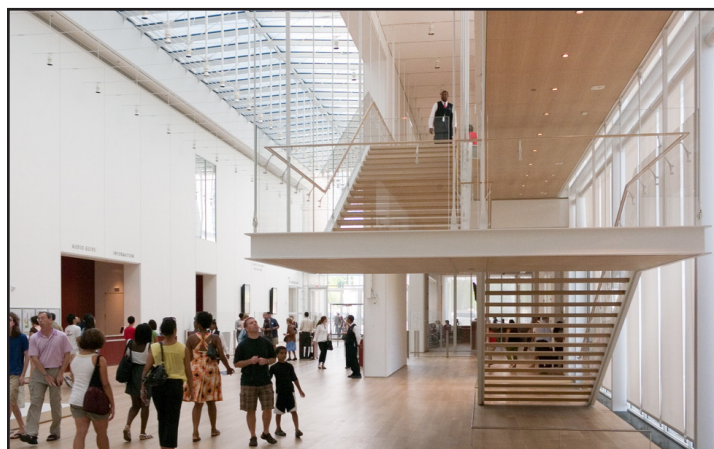

# Art Institute of Chicago - Modern Wing

Chicago, Illinois





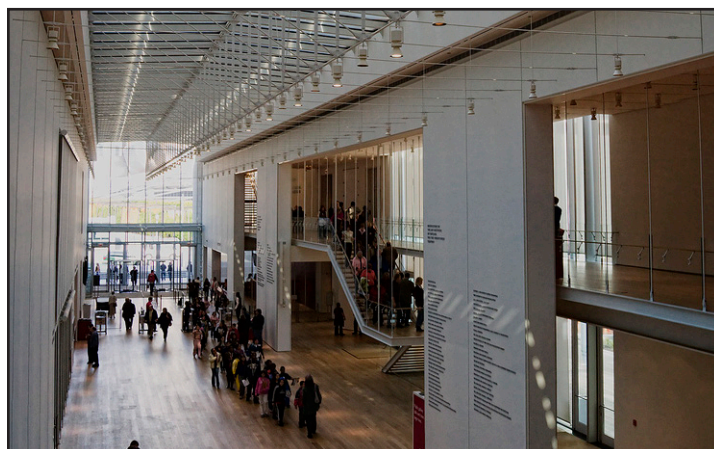

meet any application requirements. The Titus MP is an optional plenum for use with the ML modulinear series. When combined with the ML diffuser, the MP provides a tight horizontal air pattern that clings to the ceiling even at low volumes.

## THE END RESULT

The addition of the new Modern Wing allows the Art Institute of Chicago to be viewed as an upper echelon facility. The new space makes the Art Institute the second largest museum in the United States, one that houses an extraordinary collection of art, sculptures and photography that satisfies the artistic and cultural needs of the many patrons who will visit this impressive facility.

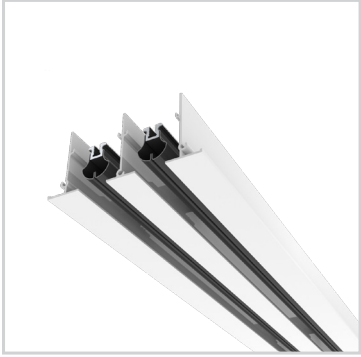

## Titus Products List

			
<b>ML</b>	<b>TMRA-AA</b>	<b>300/350R</b>	<b>MP</b>
The DynaFuser is an auto-changeover plenum slot diffuser for use in perimeter applications that provides both heating and cooling.	The OMNI-NT diffuser is a ceiling diffuser that gives a uniform 360 degree horizontal air pattern without excessive noise or pressure drop.	The FlowBar linear diffuser delivers higher airflow with lower noise levels.	The ML-TZ TechZone Modulinear diffuser is a high performance diffuser that utilizes "ice tong" deflector blades to change the air volume and direction from the face of the unit.

Address - 605 Shiloh Rd Plano Texas 75074

Office - 972.212.4800

Fax - 972.212.4877

E-mail - [titus@titus-hvac.com](mailto:titus@titus-hvac.com)

Websites - [www.titus-hvac.com](http://www.titus-hvac.com) | [www.titus-energysolutions.com](http://www.titus-energysolutions.com)

© Copyright Titus 2011 | All rights reserved

